

## **LEGOM 2/3 ports fancoil valves**



Fan-coil control valves used for controlling the flow of hot or cold water in heating and air conditioning systems.

They are operated by electric actuators with max. stroke of 2.5 mm, such as Wisse thermal actuator(included in the package).

As standard, the valves are available in the configuration with male thread in the following versions :

- 2-way series
- 3-way series

Operation of the valve plug is by Wisse thermal actuator, available in the following version:

- NC (normally closed) 2-wire

Actuators can easily be fastened to the valve body with a threaded ring nut. (M30x1.5).

Complete range:

- 2-way series - 1/2", 3/4", 1"
- 3-way series - 1/2", 3/4", 1"

### **Technical parameters:**

Technical parameter:

Max pressure: 10 bar

Min. fluid temperature: 4°C

Max. fluid temperature: 110°C

Liquids which can be used: Water (with glycol≤50%)

Plug stroke: 2.5 mm

By-pass leakage: <0,02 % Kvs

Actuator connection: Threaded ring nut M30 x 1.5

Body: Brass

Stem: Brass with chemical nickel-plating

Spring: Stainless steel

Plug rubber: EPDM



**Flow rates**

**2-way series**

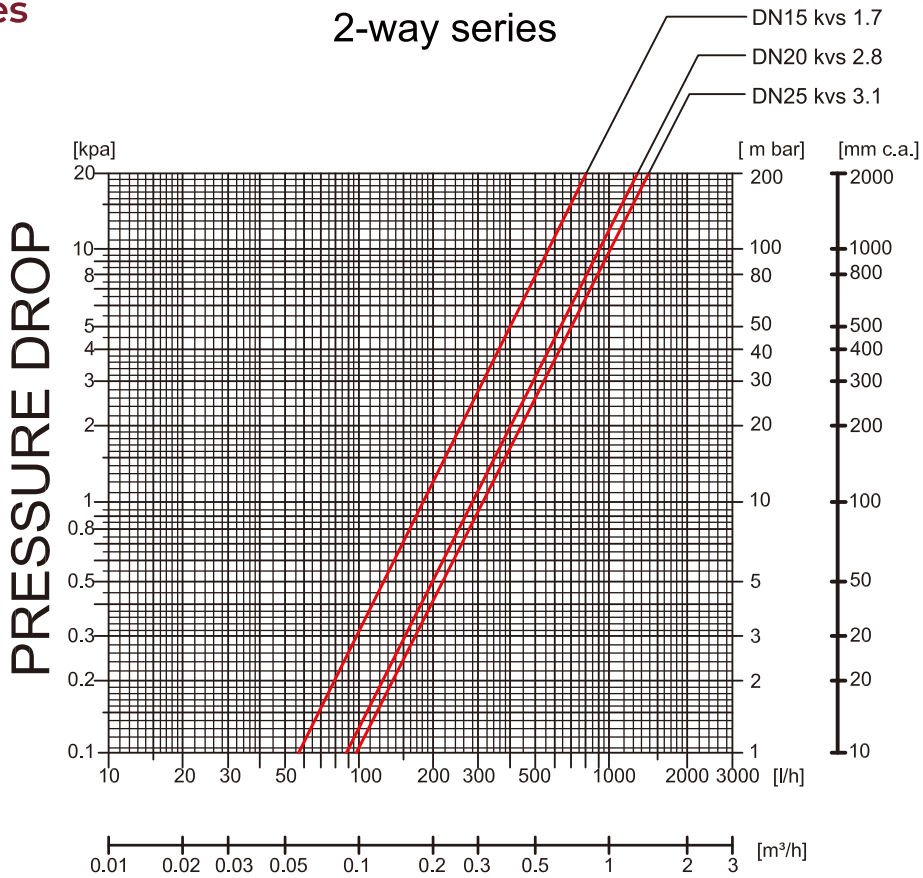

**FLOW RATE**

**3-way series  
DN 15**

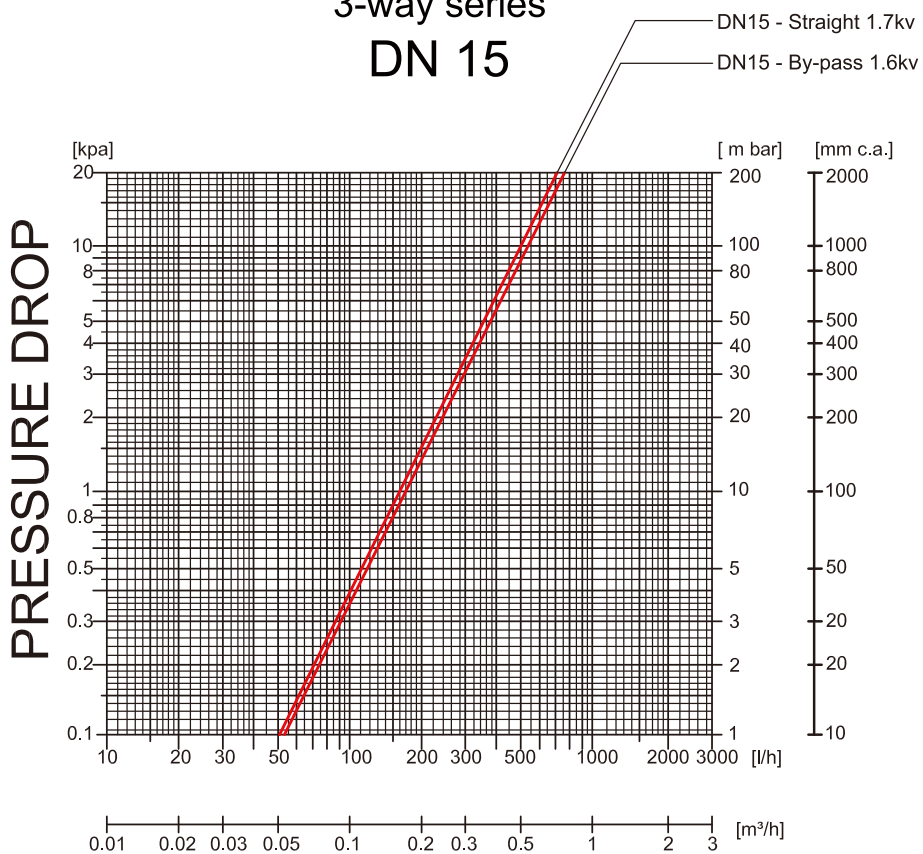

**FLOW RATE**

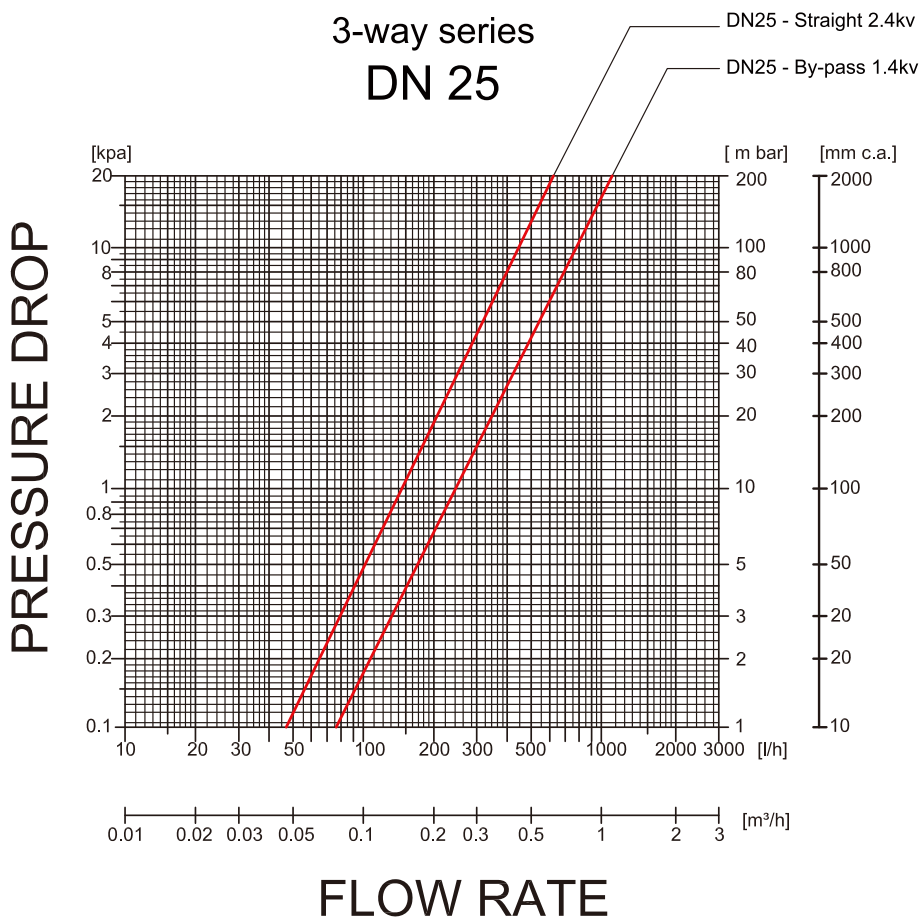
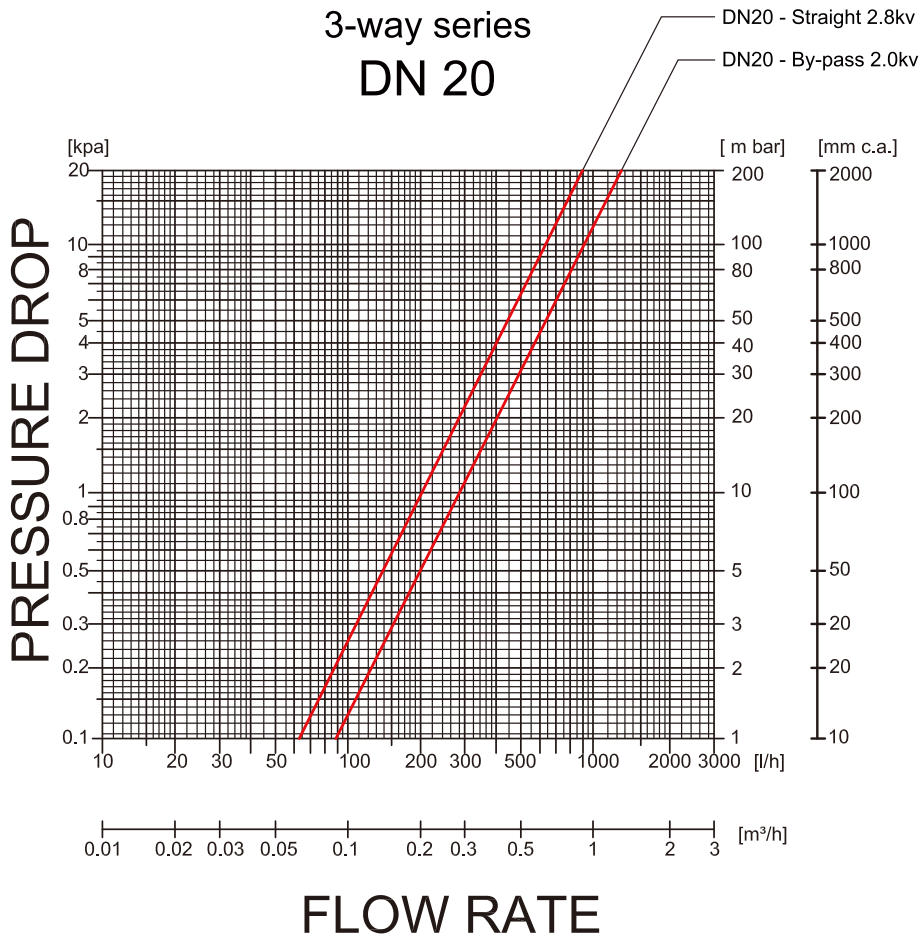



## Application

The valves are used for shutting off or diverting/mixing (2-way and 3-way size 1/2", 3/4", 1"), the heat transfer fluid to a heating or air conditioning system as required by the room thermostat (or timing thermostat). In case of 3-way fan-coil valves, thanks to the special configuration of the plug controlling the by-pass flow, can be used equally well as diverting or mixing valves (thus optimizing to the full the various plumbing requirements in assembly).

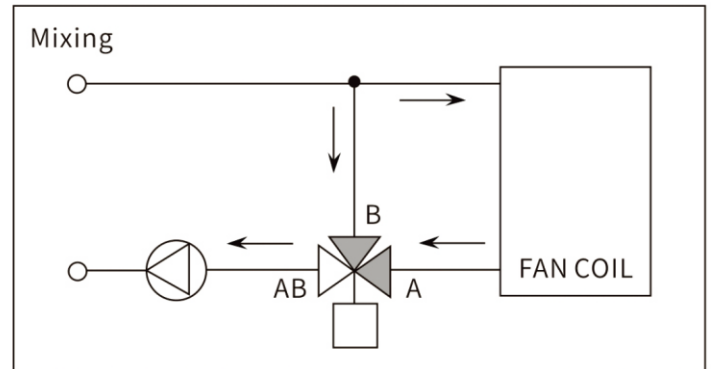
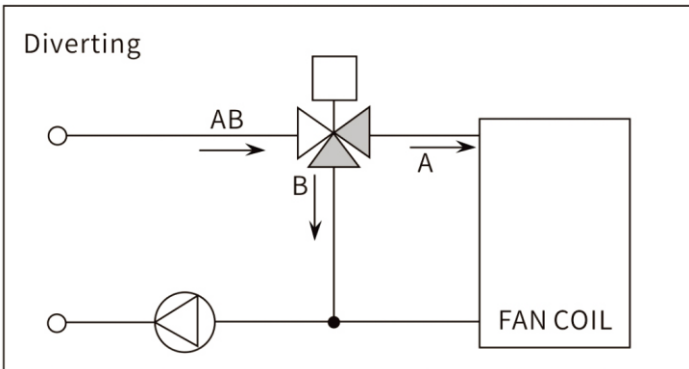

## Dimensions:

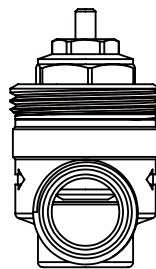
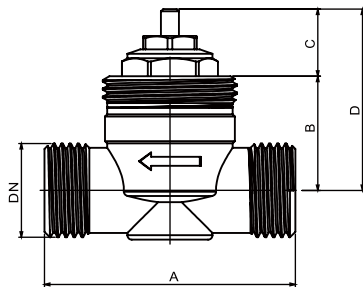

DN	A	B	C	D
1/2"	56	25.5	15	40.5
3/4"	58	24.5	15	39.5
1"	65	24.5	15	39.5

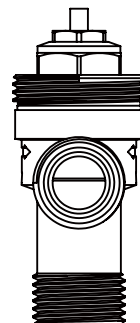
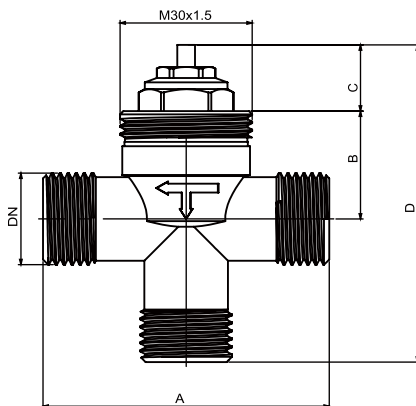

DN	A	B	C	D
1/2"	65	24.5	15	72
3/4"	65	24.5	15	72
1"	65	24.5	15	72